

# PERAQUA®

pooled family pleasure



**Better  
Safe Than  
Sorry**  
*Safety and  
functionality for  
many years*

**PRAHER**  
PLASTICS 



# MILLIONS SOLD – TRUSTED AROUND THE WORLD

- Operation temperature up +60 °C/140 °F
- Best flow rates due to non-reduced diameter
- High durability due to ball seating ring made of PTFE or PE
- Low weight
- Radial installation and disassembly
- Double shaft sealing
- UV resistant
- Corrosion-free
- Double side blocked body design offers more safety (pic 2)
- 100 % function and leak test after assembly
- 100 % pure PVC (pic 1)



According to EG-VCM safety regulation.

- General:**
- Material: PVC-U
  - Sealing materials: EPDM/FPM
  - Ball seating joint: PTFE/PE
  - Dimensions: DN3"–DN4"

- Connector types:**
- Solvent socket: DIN/ASTM/JIS
  - Solvent spigot: DIN
  - Threaded socket: BSP/NPT
  - PE fusion spigot: DIN
  - PE fusion socket: DIN

**Operating pressure:**  
PVC: DN3/8"–DN3", DN4"

**Dimensions:**

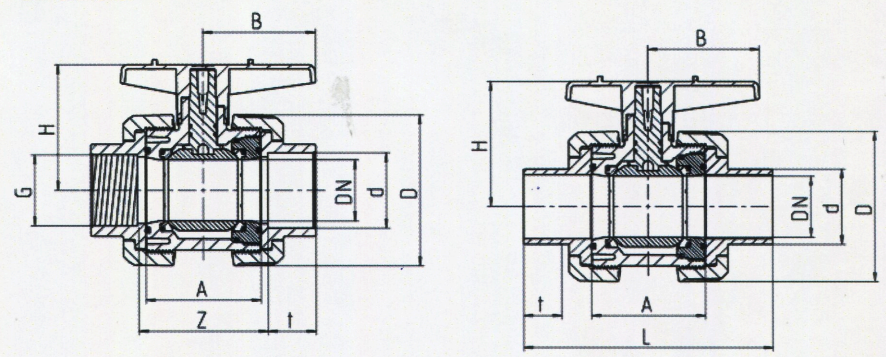

- Exploded drawing:**
1. Handle
  2. O-Ring
  3. Shaft
  4. Body
  5. O-Ring
  6. O-Ring  
(only at DN80)
  7. Ball seating joint
  8. Ball
  9. O-Ring
  10. Thrust collar
  11. Connector types  
solvent socket/spigot  
threaded socket  
fusion socket/spigot
  12. Union nut

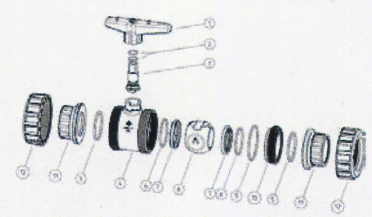

**PVC-U**

Connection types  
PVC solvent socket/solvent spigot/threaded socket  
PE fusion socket/fusion spigot

DN	10	15	20	25	32	40	50	65	80	80
d	16	20	25	32	40	50	63	75	90	110
G <sup>TSO</sup> <sup>1</sup>	3/8"	1/2"	3/4"	1"	1 1/4"	1 1/2"	2"	2 1/2"	3"	4"
A	44.5	44.5	50	52.5	61	77	87	110	136	136
B	42.5	42.5	55	55	65	75	75	111	133.5	133.5
D	55.5	55.5	62	70	87	101.5	115.5	144.5	180.5	180.5
H	47	47	53	55.5	76	88.5	98	126	150.5	150.5
t <sup>SSO</sup> <sup>2</sup>	16.5	16.5	19.5	22.5	26.5	31.5	38.5	45	56.5	61
t <sup>SSP</sup> <sup>3</sup>	17	17	20	22.5	26.5	31.5	38.5	45	54	-
t <sup>FSP</sup> <sup>4</sup> PE	13	14.5	15.5	18.5	15.5	29	31	32	30	-
t <sup>FSO</sup> <sup>5</sup> PE	14.5	16	17	19.5	22	25	29	31.5	38	42
Z <sup>SSO</sup> <sup>2</sup>	51	49	56	58	68	85	98	121	153	162
Z <sup>TSO</sup> <sup>1</sup>	50	50	57	60	67	86	98	123	156	-
Z <sup>FSO</sup> <sup>5</sup> PE	54	51	60	64	75	97	115	138	182	186
L <sup>SSP</sup> <sup>3</sup>	98	107	125	133	151	176	201	260	297	-
L <sup>FSP</sup> <sup>4</sup> PE	95	105	123	130	119	162	175	226	266	-
PN <sub>PVC</sub>	16	16	16	16	16	16	16	16	16	16
PN <sub>PE</sub>	16	16	16	16	16	16	16	16	16	10

<sup>1</sup> TSO = threaded socket  
<sup>2</sup> SSO = solvent socket  
<sup>3</sup> SSP = solvent spigot  
<sup>4</sup> FSP = fusion spigot  
<sup>5</sup> FSO = fusion socket  
- = currently not realized

Dimensions in mm

*This document does not constitute a guarantee, it is for initial information purposes only. The product range is continually upgraded, the designs and types therefore only reflect the state of the art at the time of printing. Subject to technical modifications!*



**Diagrams:**

Flow characteristics:

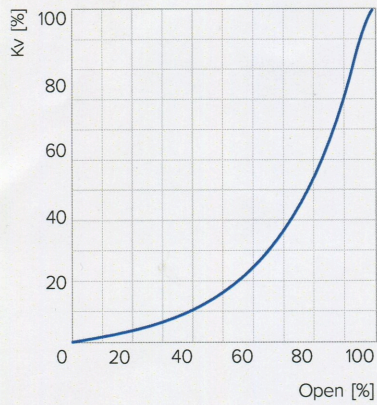

Pressure temperature diagram:

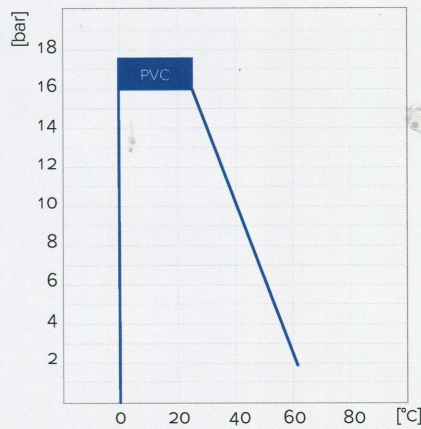

Pressure loss diagram:

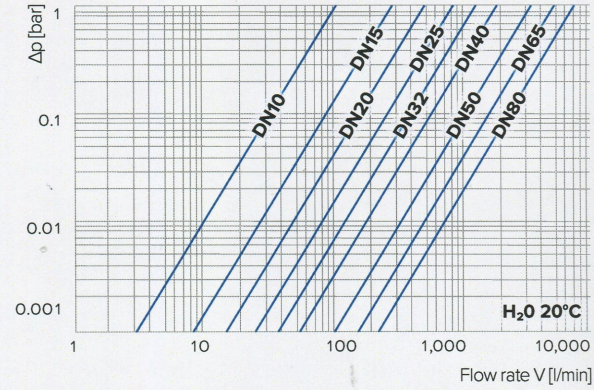

Pressure loss*	DN10	DN15	DN20	DN25	DN32	DN40	DN50	DN65	DN80
0.001 bar	4.1	6.3	13.3	20.5	28.4	44.2	82.2	143.8	212.5
1 bar	130	200	420	650	900	1400	2600	4550	6720

l/min

# PVC CONE CHECK VALVE TYPE S4

PTFE-TEFLON COATED STEEL SPRING

Pools which are operated by salt electrolysis systems, low concentrated chlorine & other chemical liquids (for more details ask for our chemical resistance lists). Installation in horizontal and vertical position possible.



## FURTHER PRODUCTS FROM PRAHER PLASTICS



**Diaphragm Valve T4**

d20 1/2"–d140 5"



**3-way Ball Valve S4**

d20 1/2"–d63 2"



**Laboratory Ball Valve S4**

1/4", 3/8"



**Cone Check Valve S6**

d40 1 1/4"–d63 2"

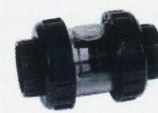

**PVC IBG/PRAHER pressure fittings**

d16–d400



**Butterfly Valve K4**

d75 2 1/2"–d225 8"



**PVC IBG FlexFit**

d50 1 1/2"–d63 2" for PVC flex hose, PVC and PE pipe



**PVC Pressure Pipe**

d16–d400 PN6, 10 and 16



**Wafer Check Valve K6**

d50 1 1/2"–d315 12"



**Wafer Check Valve K4**

d75 2 1/2"–d315 12"







RESPONSIBLY  
PRODUCED



Complete equipment for all types of pools.

IMPRINTED CO.AT

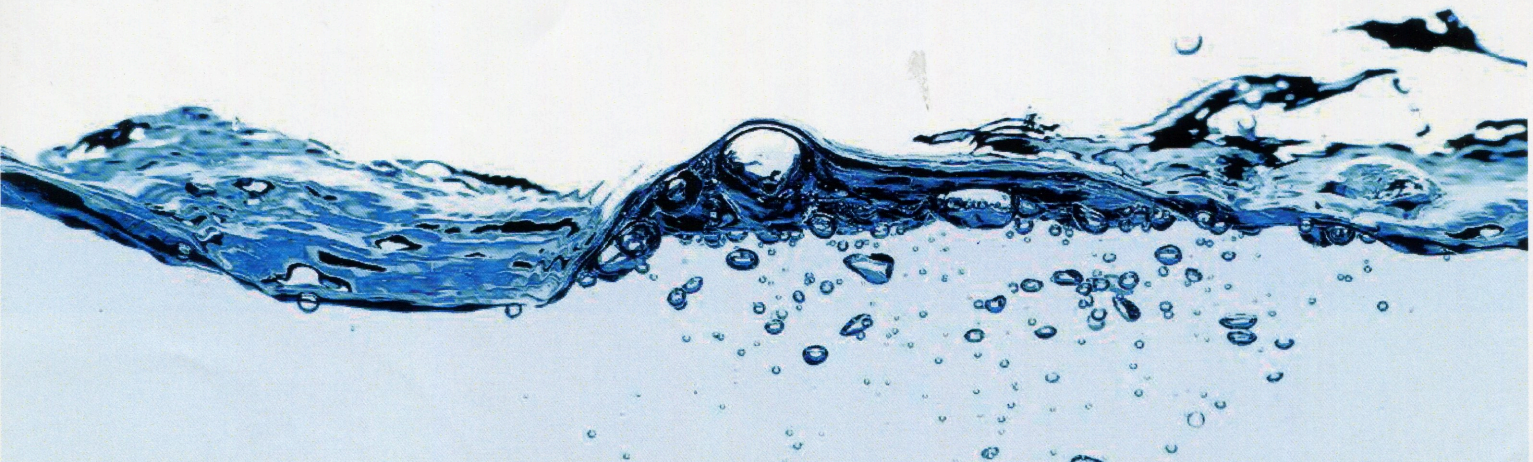

# PERAQUA®

pooled family pleasure

## HEAD QUARTER AND EXPORT

### Peraqua Professional Water Products GmbH

Handelsstraße 8  
4300 St. Valentin

T. +43 7435/58488-0  
F. +43 7435/58488-2009

info@peraqua.com  
www.peraqua.com



## SALES, LOGISTICS AND TECHNICS

### PERAPLAS DEUTSCHLAND GMBH

Regensburger Ring 12, 91154 Roth  
T. +49 9171 9677-1200, F. +49 9171 9677-2209  
office.de@peraplas.com

### PERAPLAS ČESKO s.r.o.

25101 Říčany-Jažlovice, Zdebradská 62  
T. +420 323 63 76-73, F. +420 323 63 76-72  
office.cz@peraplas.com

### PERAPLAS Praher Middle East FZE

PO Box No. 122435, Plot No. Q4-99,  
SAIF Zone, Sharjah, UAE  
T. +971-6-557 98 66, F. +971-6-557 97 07  
office.ae@peraplas.com

Member of **PRAHER  
GROUP**